

Accessories for Downhole Gauges: **Battery Packs**



1 X "AAA"
4 Pin Lemo



1 X "AA"
4 Pin Lemo



1 X "C"
4 Pin Lemo



1 X "C"
Threaded Locking
4 Pin Lemo

AAA - 4 Pin Lemo Connector					
Size	Max Temp	Volts	Ahr	Part No.	Products
AAA	150°C	3.6	0.7	104284	1/2" Piezo
	165°C			104287	

AA - 4 Pin Lemo Connector					
Size	Max Temp	Volts	Ahr	Part No.	Products
AA	150°C	3.6	1.6	100408	3/4" Piezo (Standard, Welded, Accelerometer) 3/4" Quartz DXB 1" Quartz DXB 1" Side Pocket Geothermal 3/4" Inclinator 3/4" Vibration
	165°C			100804	
	180°C			100805	
	200°C			100409	
2 X AA	150°C	3.6	3.2	100411	
	165°C			100806	
	180°C			100807	
	200°C			100412	

AA - Threaded Locking 4 Pin Lemo Connector					
Size	Max Temp	Volts	Ahr	Part No.	Products
2 X AA	150°C	3.6	3.2	105262	1-1/4" Burst
	165°C			105263	
	180°C			105264	

C - 4 Pin Lemo Connector					
Size	Max Temp	Volts	Ahr	Part No.	Products
C	150°C	3.6	6.5	100671	1-1/4" Piezo (Standard, RTD, Welded III)
	165°C			100499	
	180°C			100500	
1 X CC	150°C	3.6	15.0	101010	
	165°C			100989	
	180°C			100814	

C - Threaded Locking 4 Pin Lemo Connector					
Size	Max Temp	Volts	Ahr	Part No.	Products
C	150°C	3.6	6.5	101268	1-3/8" Piezo (Welded) 1-1/4" Quartz VQ Production Logging Tools (Basic, Mini)
	165°C			101269	
	180°C			101270	
	200°C			101271	
1 X CC	150°C	3.6	15.0	102362	
	165°C			102240	
	180°C			105234	
2 X CC	150°C	3.6	30.0	102780	1-1/4" Quartz DXB 2
	165°C			102927	
	180°C			102928	
3 X CC	150°C	3.6	18.0	102929	
	165°C			45.0	
	180°C			102381	
	200°C			102381	
3 X CC	150°C	3.6	42.0	102937	
	165°C			31.5	
	180°C			102938	
	200°C			102939	

Accessories for Downhole Gauges: **Battery Packs**



1 X "Sub CC"
Threaded Locking
4 Pin Lemo

Sub CC - Threaded Locking 4 Pin Lemo Connector						
Size	Max Temp	Volts	Ahr	Part No.		
Sub CC	150°C	3.6	10.0	100808	1-1/4" Piezo (Welded II) 1-1/4" Quartz DXB	
	165°C		9.0	100226		
	180°C		7.0	100885		
	200°C		6.5	100227		
2 X Sub CC	150°C		20.0	101660		
	165°C		18.0	101000		
	180°C		14.0	102023		
	200°C		13.0	101001		

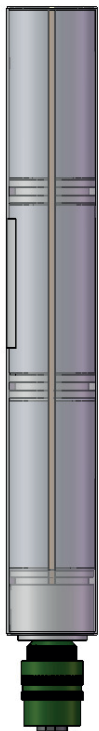

3 X "C"
4 Pin Amphenol

C/D- 4 Pin Amphenol Connector							
Size	Max Temp	Volts	Ahr	Part No.	Products		
2 X C	150°C	7.3	6.0	102376	Digital Clock		
	165°C		5.5	103543			
3 X C	150°C		11.0	12.0	100639	2-3/8" Quick Shut In Tool 3-1/2" Quick Shut In Tool 4-1/2" Quick Shut In Tool	
	165°C			11.0	100203		
3 X D	150°C			10.0	103586		
	165°C			10.0	103587		
	180°C	6.5		103588			

D- Logger Battery Pack					
Size	Max Temp	Volts	Ahr	Part No.	
2 X D	85°C	3.6	34.0	101472	Wellhead Logger Surface Logger

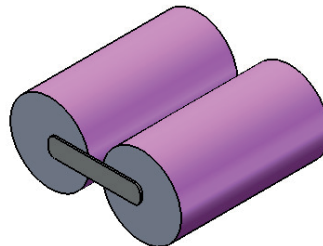

2 X "D"
Logger Battery Pack