

Accessories for Downhole Gauges: **Gauge Carrier**

Features

- ✦ High Tensile Strength
- ✦ High External/Internal Burst/Collapse Strength
- ✦ Metal to Metal Seals with Double O-Ring Backup
- ✦ 2-4 Gauge Carrying Capacity
- ✦ Capability to Measure Internal or External Pressures
- ✦ Custom sizes available upon request

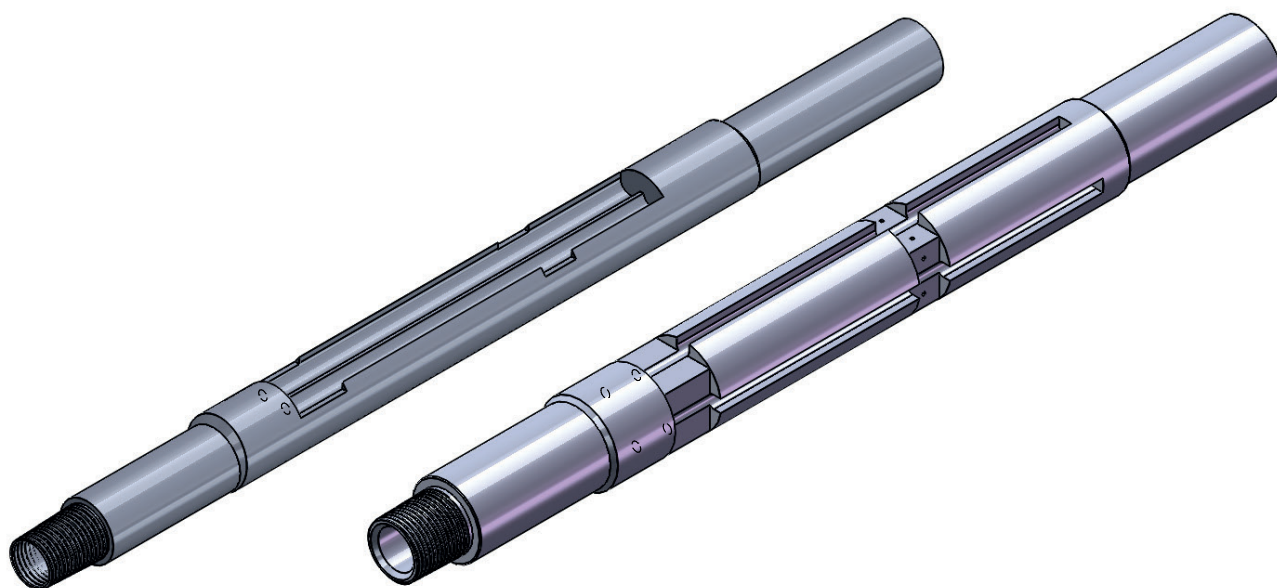

| 4140 Gauge Carrier | | | | | |
|--------------------|------------|-------------|----------------|------------------|----------|
| Burst | Collapse | Tensile | Thread | Carries | Part No. |
| 15,000 psi | 15,300 psi | 198,000 lbs | 2-7/8" EUE | 2 x 0.75" Gauges | 104228 |
| 15,000 psi | 15,300 psi | 198,000 lbs | 2-7/8" Premium | 2 x 0.75" Gauges | 104229 |
| 10,150 psi | 10,500 psi | 202,000 lbs | 3-1/2" EUE | 2 x 1.25" Gauges | 104230 |
| 10,150 psi | 10,500 psi | 202,000 lbs | 3-1/2" Premium | 2 x 1.25" Gauges | 104231 |

| Accessory Type | Part No. |
|-------------------------------------|----------|
| Polaris Carrier Adapter - Internal | 103013 |
| Polaris Carrier Adapter - External | 103014 |
| Polaris Carrier Adapter Redress Kit | 103017 |